

8" Pressure Hatch for Oilfield Service



Features

Heavy duty weld-on hatch suitable for oilfield service applications requiring an 8" opening. Recommended working pressure of up to 25 PSI. Lockable hatch has a "Speed Ball Handle" with hinge that allows quick opening and closing. Standard O-Ring is Buna-N.

1197

Part No.	Size	Weight	Material:
1197-09-8000	8"	25 Lbs	Mild Steel and heavy-duty Cast Iron Handle

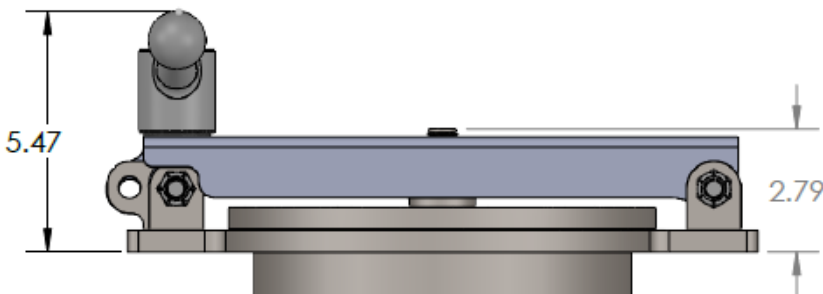

Maintenance Note:

Check gaskets periodically for cracking or UV damage, replace if necessary.

