

650

Part No.	Size	Wt./Lbs.	DESCRIPTION
650-09-2000	20"	82	S.P. W/ 1/4" Lid
650-09-2200	22"	93	S.P. W/ 1/4" Lid
650-09-2400	24"	104	S.P. W/ 1/4" Lid

Features

Non-pressure manway that conforms to API specifications for roof manways. Made of 1/4" Mild Steel. Gaskets and bolts & nuts available as options.

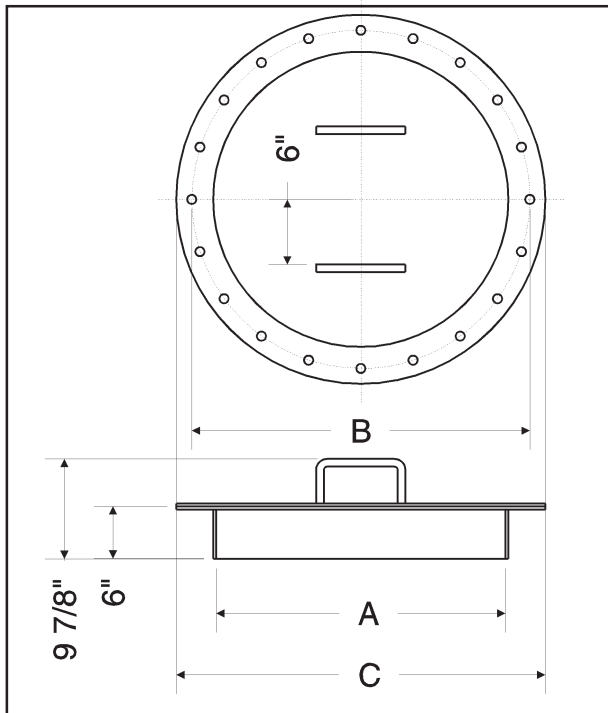

Size	A	B	C
20"	20"	23.5"	26"
22"	22"	25.5"	28"
24"	24"	27.5"	30"