

FLUSH BOXES



280

Part No.	Size	lbs	A	B	C
0280-01-2000	2"	2.3	2"	1 7/8"	3 1/16"
0280-01-3000	3"	5.0	3"	3"	4"
0280-01-4000	4"	10.0	4"	2 3/8"	5 3/4"

Wrench no. 0280-01-2004

Features

Water tight, flush mounted fill box. Designed for traffic areas not requiring locking security. Ideal for waste oil and fuel oil applications. Heavy duty cast iron base, quick opening brass lid, gasket and wrench are standard.

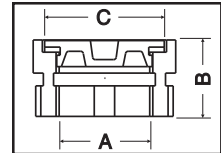

290

Part No.	Size	lbs	A	B	C
0290-01-2000	2"	7.8	2"	4 7/16"	5 9/16"
0290-01-3000	3"	11.0	3"	5 1/8"	6 5/8"

Features

Water tight, flush mounted dual entry fill box. Both lids are threaded, with the bottom lid being lockable for security. Ideal for fuel oil, waste oil or diesel. Heavy duty cast iron body, brass lid, gasket and wrench are standard.

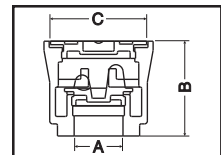

291

Part No.	Size	lbs	A	B	C
0291-01-2000	2"	7.8	2"	5"	3"
0291-01-3000	3"	11.0	3"	4 7/16"	5 9/16"
0291-01-4000	4"	21.0	4"	5 1/8"	6 5/8"

Features

Water tight, flush mounted dual entry fill box. Top lid is quick opening, with the bottom lid lockable for security. Ideal for waste oil, fuel oil and diesel. Heavy duty cast iron body, brass lids, gaskets and wrench are standard.

