

# FILLCAPS



**254**

Part No.	Size	lbs	A	B
0254-01-2000	2"	3.0	2"	2 3/4"
0254-01-3000	3"	5.0	3"	2 3/4"
0254-01-4000	4"	9.3	4"	3 3/4"

## Features

Lockable, watertight fillcap made of all cast iron. Lid is lockable in any position, suitable for fill ports on storage tanks. Brass lid available.

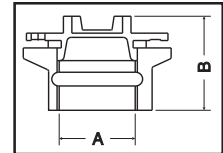

**500**

Part No.	Size	lbs	A	B
0500-01-2000	2"	1.8	2"	1 3/4"
0500-01-2500	2 1/2"	2.5	2 1/2"	1 3/4"

## Features

Lightweight female threaded fillcap. Loose fitting hinged lid is lockable and fits on a 2" pipe. Cast iron lid and collar construction. Available embossed with customer name in lots of 500.

