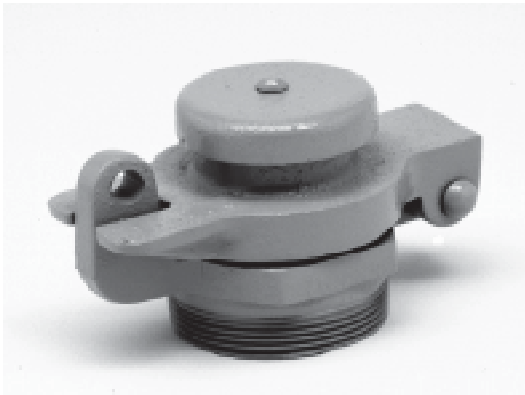
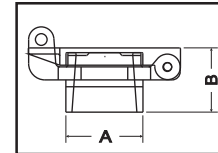

**FILLCAPS****233**

Part No.	Size	lbs	A	B
0233-01-2000	2"	1.75	2"	2 3/4"
0233-01-3000	3"	2.5	3"	4"

**Features**

A lightweight, durable male thread fillcap. Cast iron material with a lockable lid. Available embossed with customer name in lots of 500 or more.

**234**

Part No.	Size	lbs	A	B
0234-01-2000	2"	2	2"	3"

**Features**

A lightweight, durable male thread fillcap. Cast iron material with a lockable lid. Top has a screened opening in cover for venting.

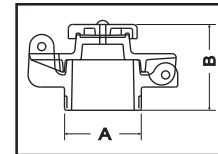
**235**

Part No.	Size	lbs	A	B
0235-01-2000	2"	1.5	2"	2.5"
0235-01-2500	2 1/2"	2.25	2 1/2"	2 3/4"

**Features**

A lightweight, durable male thread fillcap. Cast iron material with a lockable lid. Available embossed with customer name in lots of 500 or more.

